



Technical Specification: Thermal Commercial Door

“Adapting to a changing environment”

A thermally efficient product designed for installation in **schools, offices and commercial buildings** where enhanced building regulations and security standards are required. This fully compliant Thermal Commercial Pivot Door is designed for high traffic footfall and tested to **PAS 24** security standards.

The DDA compliant door system is compatible with the Kestrel Thermal Framing and Window systems providing commonality of design and an all in one solution.

Slim line profiles minimise sight lines whilst ensuring excellent thermal performance all year round.

PAS24 Configurations

- Single & Double Door
- Communal Entrance Locking
- Panic Hardware

Design Options:

- Single & Dual Colour
- Double & Triple Glazing
- Manual Pivot Door
- Automatic Pivot or Sliding Door
- Single or Multipoint Lock
- Range of DDA compliant thresholds
- Anti-finger trap stile

Design Standards:

- Tested to achieve PAS24
- BS EN 14351-1
- BS EN 12020-2
- BSEN ISO 10077-2
- BS EN 12206-1
- BS EN 3987

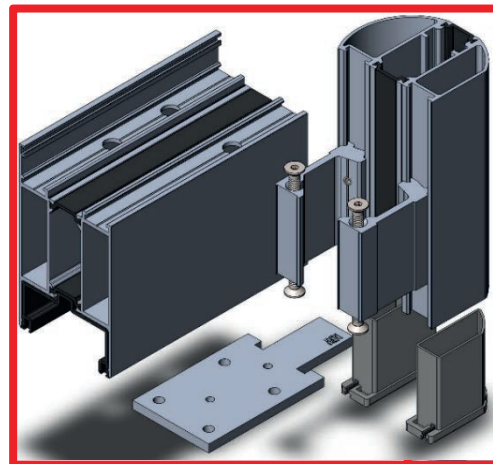

	Single Door	Double Door
Maximum Width	1100mm	2200mm
Maximum Height	2500mm	2500mm
Jointing	Mechanical	Mechanical
Internally Beaded	✓	✓
Glazing Thickness	28mm – 47mm	28mm – 47mm

KESTREL
ALUMINIUM SYSTEMS

Due to Kestrel Aluminium Systems' policy of continued product development and reserves the right to alter any of the specifications in this document without prior notice

Kestrel Aluminium Systems Ltd
Website: www.kestrelaluminium.co.uk
Email: info@kestrelaluminium.co.uk

180 Rupert Street, Aston, Birmingham, B7 5DT
Tel: 0121 333 3575
Fax: 0121 333 5335

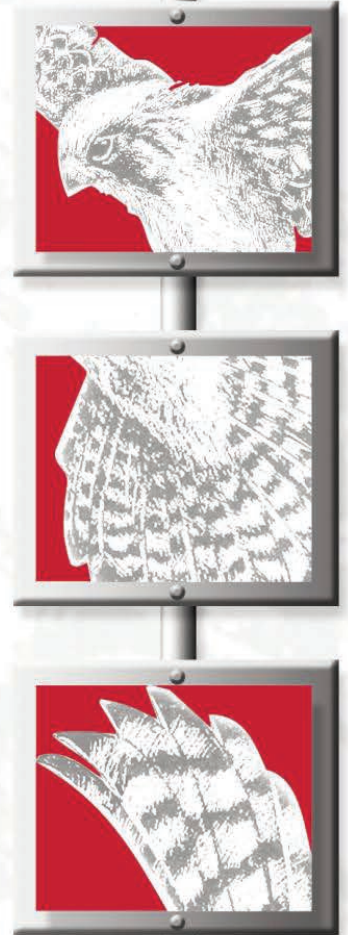

About us:

Kestrel Aluminium Systems offers fenestration solutions to the Fabricator, Contractor and Specifications markets.

We pride ourselves on:

- Excellent customer service
- Quality Technical Support
- Quick order completion
- Efficient purchasing process

KESTREL
ALUMINIUM SYSTEMS

Kestrel Aluminium Systems Ltd
Website: www.kestrelaluminium.co.uk
Email: info@kestrelaluminium.co.uk

180 Rupert Street, Aston, Birmingham, B7 5DT
Tel: 0121 333 3575
Fax: 0121 333 5335